

Industrial vacuum cleaners, tilting chassis, wet + dry, 2000 W, 70 l / 3000 W, 90 l

Operating instructions

12.2024

en-GB



Copyright

This document must not be distributed or reproduced, not even in part.

Copyright of this document remains with Jungheinrich PROFISHOP AG & Co. KG.

Haferweg 24

22769 Hamburg, Germany

For service enquiries and orders

Germany

0800 / 558833 - 4

service@jh-profishop.de

International

service@jungheinrichshop.com

Contents

A	About this manual	4
B	Security	6
1	Correct Use and Application	6
2	Rights and duties	7
3	Safety information for specific operating phases	8
3.1	Commissioning, transport and storage	8
3.2	Operation	8
3.3	Maintenance and cleaning	9
4	Conversions and modifications	10
C	Structure and function	11
1	Assembly Overview	11
2	Functional Description	12
3	Controls	12
4	Marking and labelling	13
4.1	Data plate	13
D	Technical Specifications	14
1	Performance data	14
2	EN norms	14
E	Commissioning, transport and storage	15
1	Using the Truck for the First Time	15
2	Transport	15
F	Operation	16
1	Checking the device before daily use	16
2	Starting up the device	16
2.1	Preparing the device for dry vacuuming	17
2.2	Preparing the device for wet vacuuming	18
2.3	Preparing the truck for operation	19
2.4	Switching the device on and off	19
3	Parking the truck securely	19
G	Maintenance and repair	20
1	Faults and troubleshooting	20
2	Maintenance	22
2.1	Filter replacement	22
3	Cleaning	22
H	Shutdown, decommissioning and disposal	24
1	Decommissioning	24
1.1	Shutting down and storing the device	24
1.2	Recommissioning after shutdown	24
2	Decommissioning and disposal	24

A About this manual

These operating instructions describe the correct use of the products listed in the "Scope" chapter – see page 4. All Jungheinrich products are developed and produced according to the current state of the art. However, risks can arise in the case of incorrect use. Please observe the corresponding information and read through the operating instructions carefully. The operating instructions form part of the device and are valid for all specified device versions. The operating instructions describe the safe and correct use of the device in all operating phases.



Any technical questions should be directed to your authorised service partner.

The device outlined in these operating instructions is an industrial vacuum cleaner for the removal of dust and liquids.

Scope of application

This document applies to the following devices:

- Industrial vacuum cleaner, tilting chassis, wet + dry, 2000 W, 70 l
- Industrial vacuum cleaner, tilting chassis, wet + dry, 3000 W, 90 l

Target groups

For the purposes of these operating instructions the "owner" or "operator" is defined as any natural or legal person who either uses the described device himself or on whose behalf it is used. In special cases (e.g. rental), the owner is considered to be the person who is charged with the specified operational duties in accordance with existing contractual agreements between the owner and operator of the device.

Target group	Tasks
Owner	<ul style="list-style-type: none">– Keep these operating instructions accessible at the usage location of the device, including for later reference.– Ensure that the device is used correctly and only by trained and authorised personnel.– Instruct employees to read and observe these operating instructions and other applicable documentation, particularly the safety instructions and warnings – see page 6.– Observe additional device-specific provisions and regulations.
Operator	<ul style="list-style-type: none">– Read and observe these operating instructions and other applicable documentation, particularly the safety instructions and warnings see page 6.– Ensure that the device is used correctly and in accordance with the safety regulations.

Tab. 1: Owner and operator duties

Structure of warnings

Warnings are used in this document to highlight potential causes of personal injury or material damage.

- Always read and observe these warnings.
- Follow all measures highlighted by the relevant warning.

The following warning levels are used to reflect the severity and probability of the relevant hazard:

DANGER!

Indicates an extremely dangerous situation. Failure to observe this warning can lead to serious, irreversible injuries or death.

WARNING!

Indicates an extremely dangerous situation. Failure to observe this warning can lead to serious, irreversible injuries or death.

CAUTION!

Indicates a dangerous situation. Failure to observe this warning can lead to minor or moderate injuries.

NOTICE

Indicates a risk of material damage. Failure to observe this warning can lead to material damage.

General information



Indicates additional information and explanations.

Structure of instructions

Instructions in this document are structured as follows:

Aim of the described activity

Requirements

- Prerequisites for activity

Tools and Material Required

- Tools and materials required for an activity (optional specification)

- Step
- Step
 - Sub-step

Result of action

B Security

The safety chapter provides important information on how to work safely with the described product. Failure to observe the specified measures can result in material damage and injuries, and potentially even death.

- Before commissioning and operating the device: Read the safety chapter thoroughly.
- Use the described device only as specified in this document.

1 Correct Use and Application

The device described is suitable for:

- Vacuuming up water exclusively without motor protection filter
- Vacuuming up dry dirt exclusively with motor protection filter

All liability and warranty claims are void:

- In the event of damage caused as a result of improper use
- In the event of damage caused as a result of misuse

For commercial applications, a 5-minute break is required after a maximum of 30 minutes of operation.

Correct environmental conditions

The device will be permanently damaged if exposed to extreme environmental conditions.

- Only use the device under the permitted conditions – see page 14.
- Do not use the device in areas or environments with high levels of humidity.
- Do not use the device in areas or environments at risk of explosion or fire.
- Do not use the device in very dusty areas or environments.
- Do not use the device in outdoor areas.
- Do not use the device in corrosive areas or environments.
- Do not use the device in temperatures outside the permissible temperature range – see page 14.

Possible incorrect use

Inappropriate use of the device poses a risk of injury and reduces the service life of the device.

The device is NOT suitable for the following applications:

- Vacuuming water from containers or recesses
- Vacuuming flammable or volatile liquids
- Vacuuming dust directly from or in close proximity to industrial systems (the device is not a mobile extraction unit)

Attaching accessories to the device

Obtain written authorisation from the manufacturer and the responsible authority before attaching accessories to the device.



The authority's approval does not replace the manufacturer's permission.

2 Rights and duties

Duties of the owner

Incorrect preparation of the device can result in serious damage or injuries. The owner must:

- Ensure that the device is used as intended.
- Ensure that the device is in perfect technical condition.
- Ensure compliance with all regulations concerning accident prevention, safety and disposal as well as those regarding operation, maintenance and repairs.
- Provide suitable protective equipment for the operator.
- Make the operating instructions available at the usage location.

Duties of the operator

Irresponsible operation of the device can result in serious damage or injuries. The operator must:

- Provide evidence of his or her ability to use the device.
- Provide evidence of his or her commissioning by the owner or their legal representative.
- Prevent unauthorised use of the device.
- Assume responsibility for the correct use of the device during operation.
- Independently take the device out of service and inform the relevant supervisor(s) in the case of damage to the device during operation.

3 Safety information for specific operating phases

3.1 Commissioning, transport and storage

Transporting the device safely

Incorrectly secured transports can result in material damage and personal injury.

- Secure the HGV or trailer against rolling away before loading the device.
- Correctly secure the device to the lashing rings on the HGV or trailer.

3.2 Operation

Users and certain groups of people

Unsafe operation of the device can result in significant material damage and severe personal injury.

- People (including children) with limited physical, sensory or mental capacities or lack of experience should not be allowed to use the device.
- Make the device inaccessible to these groups of people.
- Supervise children and ensure that they do not play with the device.
- Read and understand the operating instructions.
- Familiarise yourself with hazards that may arise while using the device and how to avoid them.
- Ensure that the work area is clear of other people or animals.
- Prevent unauthorised use of the device.

Danger due to electricity

Observe the following when using the device:

- Protect the device from drops of water and splashes.
- Never immerse the motor unit in liquids.
- Never rinse the motor unit with water or cleaning agents.
- Only connect the device to a correctly installed socket with a voltage that corresponds to the technical data.
- When using a socket adapter or extension cable, ensure that it complies with the applicable safety regulations.
- Do not exceed the specified maximum current.
- Unwind the connecting cable fully before use. Ensure that the connecting cable does not become stuck, crushed or damaged by sharp edges or hot objects.
- Never place the extension cable or plug in pools of water.
- Ensure that the socket is easily accessible so that the mains plug can be unplugged quickly in the event of an emergency.
- Never touch the mains plug with wet hands.

Do not touch the device if

- It is damaged
- Accessories are heavily soiled
- The connecting cable or mains plug is damaged
- It has fallen

In the following situations, the mains plug must be removed from the socket:

- If the device is not being used
- After use
- Before cleaning or storing the device (allow it to cool down completely)
- In the event of a fault during use
- During a storm



When unplugging, always pull the plug and not the mains cable.

Use the device safely.

- Do not modify the device or connecting cable.
- Do not modify the protective devices.
- Repairs must only be carried out by a specialist workshop.
- Have a damaged connecting cable repaired by the manufacturer, its customer service department or a specialist workshop.
- Do not connect the device to a timer or a separate remote-control system, e.g. a twilight switch or a remote-controlled socket.
- Unplug the mains plug from the socket before cleaning, maintenance or switching from wet to dry function.

Preventing injuries to third parties

A heightened accident risk exists for unauthorised persons in the hazardous area.

- Never vacuum people, animals – above all hairs, fingers and other parts of the body – plants and clothing while it is being worn.
- Never use the device to vacuum up toner (laser printer, photocopier).
- Never vacuum up ash, burning cigarettes or matches.
- Never vacuum up sharp objects such as glass splinters, nails, etc.
- Only use the appliance vertically.
- Never store the device outdoors.

3.3 Maintenance and cleaning

Conducting maintenance work safely

Thorough and expert servicing is one of the most important prerequisites for safe operation of the device. Failure to perform regular maintenance can result in a malfunction of the device and poses a potential hazard to personnel and equipment.

Observe the following when carrying out maintenance (e.g. a filter change).

- Carry out maintenance and repair work at regular intervals.
- Maintenance and repair work must only be carried out by specialist personnel with the requisite training.
- In the case of uncertainty, contact the manufacturer's customer service department.
- Use only original spare parts from the manufacturer.
- Immediately after any maintenance work, complete all steps for returning the device to service – see page 24.
- Do not clean the device with flammable liquids.

4 Conversions and modifications

Modifying the design and function of the device

Any conversions or changes to the design of the device which have not been approved by the manufacture can result in severe personal injury and significant material damage. All warranty and liability claims will be void.

If modifications are to be made, they require written permission from the manufacturer, an authorised representative or a legal successor. This includes, but is not limited to, the following actions:

- Changes affecting stability
- Changes affecting the control function
- Addition of attachments

Under no circumstances must the operating speed of the device be changed, not even with the manufacturer's approval.

C Structure and function

1 Assembly Overview



Item	Description	Equipment
1	ON/OFF switch	Standard
2	Motor unit	Standard
3	Drain hose	Standard
4	Collection container	Standard
5	Castors	Standard
6	Vacuum nozzle	Standard
7	Suction pipe	Standard

Item	Description	Equipment
1	ON/OFF switch	Standard
3	Drain hose	Standard
8	Motor unit tension locks	Standard
9a	Handle	Standard
9b	Tipping handle	Industrial vacuum cleaner 2000 W
10	Motor-unit handle	Standard
11	Suction-hose lock	Standard

4 Marking and labelling

4.1 Data plate

Fig. 1: Data plate (schematic)

Item	Information
a	Name and address of manufacturer
b	Article number
c	Option
d	Year of manufacture
e	Net weight
f	Protection rating
g	Power
h	Operating voltage
i	Serial number
j	Type
k	Product designation

D Technical Specifications

1 Performance data

Description	Industrial vacuum cleaner 2000 W	Industrial vacuum cleaner 3000 W	Unit
Suction function	Wet/dry	Wet/dry	-
Number of motors	2	3	-
Rated power	1000/2000	1000/2000/3000	W
Container volume	70	90	l
Dimensions	580 x 520 x 930	580 x 500 x 960	mm
Suction hose diameter	38		mm
Accessory connecting diameter	40		mm
Suction power, max.	2000	3000	W
Rated voltage, frequency	220-240, 50/60		V~, Hz
Cable length	7.2		m
Degree of protection	IP X4		-
Weight including accessories	23.4	26.9	kg

Correct environmental conditions

Condition	Value
Application area	Indoor application
Permitted ambient temperature	+5°C to +40°C
Minimum illumination	50

2 EN norms

Continuous sound pressure level

- Industrial vacuum cleaner 2000 W: ≤75 dB(A)
- Industrial vacuum cleaner 3000 W: ≤85 dB(A)

in accordance with 2006/42/EC as harmonised with EN ISO 4871.



The continuous sound pressure level is a mean value calculated according to the relevant standard. The sound pressure level is measured at the suction pipe.

Electromagnetic compatibility (EMC)

The manufacturer confirms that the appliance adheres to the limiting values for electromagnetic emissions and interference immunity as well as the static electricity discharge test in accordance with EMC Directive 2004/108/EC as well as the standardised instructions contained therein.



No changes to electrical or electronic components or their arrangement must be made without the written agreement of the manufacturer.

E Commissioning, transport and storage

1 Using the Truck for the First Time

WARNING!

Small parts than can be swallowed and breathable packaging material.

Serious injury or death due to choking.

- ▶ Keep packaging material away from children.
 - ▶ Never place bags over the head.
-

WARNING!

Damaged components!

Material damage or personal injury due to damage or other defects.

- ▶ Repair damage or other defects properly.
 - ▶ Do not use the device until it has been repaired.
-

Remove the device from the packaging.

- Remove the device and accessories from the cardboard box.
- Remove all packaging material.

Check the device before first use.

- Visually inspect the device for damage.
 - Immediately notify the relevant supervisor(s) of any damage or defects on the device or attachments.
- Clearly label a defective device and take it out of service or dispose of it.
- Only return the device to service when the fault has been rectified.
- Replace damaged hoses or accessories before use.
- Check the function of the ON/OFF switch.

2 Transport

CAUTION!

Inadequately secured transport!

Risk of material damage and personal injury due to unsecured loads.

- ▶ The device must be sufficiently secured when transported on an HGV or trailer.
 - ▶ Use the lashing rings on the HGV or trailer.
-

F Operation

1 Checking the device before daily use

Regular inspection allows faults or malfunctions to be recognised at an early stage and rectified promptly. This increases the service life of the product and helps to ensure safe operation.

Check the device for damage and defects before start-up at the beginning of a shift

- Check the device for damage.
- Check the castors for correct function and ease of movement.
- Immediately notify the relevant supervisor(s) of any damage or defects on the device or attachments.
- Take any devices with damaged or defective safety-relevant components out of service and repair them before next use.

2 Starting up the device

WARNING!

Electrical voltage!

Serious injury due to electric shock.

- ▶ Exercise particular caution when working with liquids and electrical devices at the same time.
- ▶ Never immerse the motor unit in liquids or rinse with liquids.
- ▶ Disconnect from the mains immediately in the event of contact between the motor unit and liquids.
- ▶ Disconnect from the mains before carrying out repair work.
- ▶ Never touch the mains plug with wet hands.

NOTICE

Risk of tipover!

Device damage due to tipover.

- ▶ Do not pull on the suction hose to move the device.
- ▶ Roll the device at the handle to close to the work area.
- ▶ Ensure that the connecting cable remains behind the device and do not roll over it.



When using the device for the first time, you may notice a slight odour, which is, however, harmless and will disappear after a short period of time.

Ensure good room ventilation.

2.1 Preparing the device for dry vacuuming

→ The figure shows the industrial vacuum cleaner 3000 W.



Item	Description	Equipment
2	Motor unit	Standard
6	Attachment (floor brush)	Standard
8	Motor unit tension locks	Standard
11	Suction-hose lock	Standard
12	Receptacle	Standard
13	Motor protection filter	Standard
14	Bulges	Standard
15	Upholstery brush	Standard
16	Joint brush	Standard
17	Suction hose	Standard
17a	Coupling	Standard
17b	Suction hose mounting point	Standard

Preparing the device for dry vacuuming

- Insert the motor protection filter (13) into the collection container.
- Insert the motor unit (2) at the position shown and secure with tension locks (8).

- Press the suction hose (17) with coupling (17a) into the mounting point (12) on the collection container.
- To disconnect the coupling from the collection container, press the suction-hose lock (11).
- Align the bulges (14) on the suction pipes and slide them into one another.
 - Firmly press one end into the suction pipe mounting point (17b).
 - Insert the floor brush (6) into the other end of the suction pipe.
 - Use the upholstery brush (15) and joint brush (16) on the suction hose mounting point (17b).

2.2 Preparing the device for wet vacuuming

- The figure shows the industrial vacuum cleaner 3000 W.

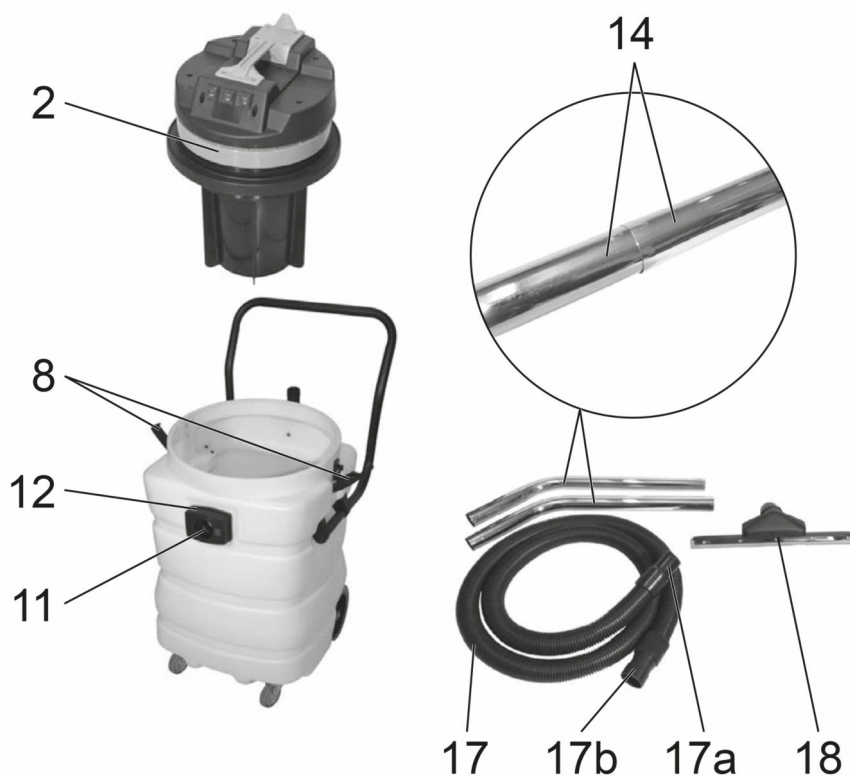

Item	Description	Equipment
2	Motor unit	Standard
8	Motor unit tension locks	Standard
11	Suction-hose lock	Standard
12	Receptacle	Standard
14	Bulges	Standard
17	Suction hose	Standard
17a	Coupling	Standard
17b	Suction hose mounting point	Standard
18	Rubber lip	Standard

Preparing the device for wet vacuuming

- Insert the motor unit (2) at the position shown and secure with tension locks (8).
 - Press the suction hose (17) with coupling (17a) into the mounting point (12) on the collection container.
- ➔ To disconnect the coupling from the collection container, press the suction-hose lock (11).
- Align the bulges (14) on the suction pipes and slide them into one another.
 - Firmly press one end into the suction pipe mounting point (17b).
 - Insert the rubber lip (18) into the other end of the suction pipe.

2.3 Preparing the truck for operation

- Connect the mains plug to the mains.
- Check the motor unit and suction hose for firm seating on the collection container.

2.4 Switching the device on and off

⚠ DANGER!

Motor overheats with continuous use

Improper use (such as continuous operation) may result in damage to the device and can pose a risk of personal injury.

► For commercial applications, a 5-minute break is required after a maximum of 30 minutes of operation.

- To switch the motor on, move the ON/OFF switch (1) into the I position.
- To switch the motor on, move the ON/OFF switch (1) into the O position.

3 Parking the truck securely

⚠ CAUTION!

Unsecured device!

Personal injury and material damage due to unsecured device.

► Never park the device on inclines, paths or in doorways.

► Always switch the device off and disconnect from the mains before leaving the work area.

Park the device securely

- Empty the collection container after use.
- Always park the device on a level surface.
- Wind the connecting cable around the motor unit and lean the suction unit against the device.
- Park the device in a dry, frost-free location.

G Maintenance and repair

1 Faults and troubleshooting

CAUTION!

Incorrect maintenance!

Risk of material damage and personal injury due to failure of important components.

- ▶ Use only original spare parts from the manufacturer.
- ▶ Maintenance and repair work must only be completed by specialist personnel with the requisite training.
- ▶ When replacing rollers, ensure that the device remains level (e.g. always replace left and right at the same time).
- ▶ Always observe the device-specific settings when carrying out repairs or replacing components.

-
- In the case of a device fault, carry out the following troubleshooting measures.
 - If you encounter problems when carrying out the measures or if they fail to rectify the problem, contact the manufacturer's customer service department.

Fault table

Fault	Possible cause	Fault rectification
Device cannot be switched on with the ON/OFF switch.	Mains socket is faulty.	Test different device in the socket
	Connecting cable is faulty.	Unplug the device and inform the manufacturer's customer service department.
	Motor unit is faulty.	Unplug the device and inform the manufacturer's customer service department.
Suction power when dry vacuuming is low.	Motor protection filter clogged.	Clean motor protection filter.
	Collection container is over full.	Clean collection container.
	Suction unit is clogged.	Clean suction hose and suction pipe.
Dust leaking.	Motor protection filter missing.	Insert motor protection filter.
	Motor unit not correctly fitted to collection container.	Check that the motor unit is firmly seated.
	Motor protection filter damaged.	Replace motor protection filter.
Suction power drops suddenly when wet vacuuming, and running noise changes audibly.	Maximum water level in collection container reached. Float in motor unit has closed the suction opening.	Empty collection container.
Reduced suction power during wet vacuuming.	Motor protection filter inserted.	Remove motor protection filter.

2 Maintenance

2.1 Filter replacement

Replacing the motor protection filter (dry vacuuming)

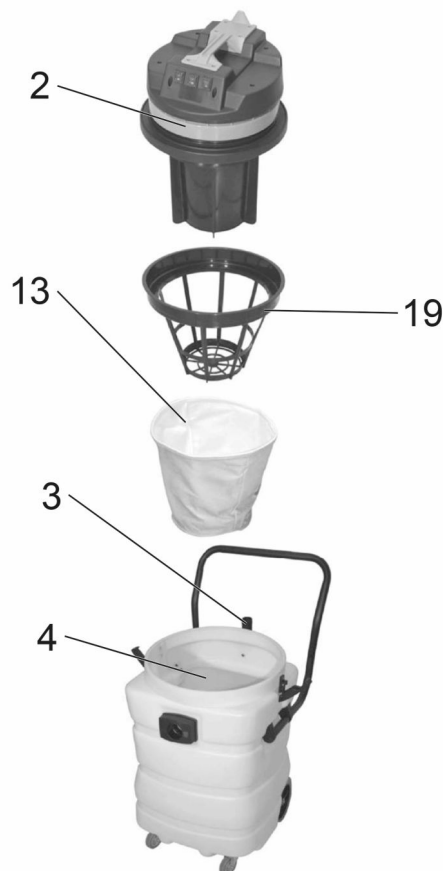

- ➔ Replace the motor protection filter (13) as required.
- Remove the motor protection filter (13) from the shoulder (19).
 - Place the new motor protection filter (13) on the basket and push the rim of the filter fully over the shoulder (19).
 - Insert the motor protection filter (13) into the Industrial vacuum cleaner.

3 Cleaning

⚠ WARNING!

Electrical voltage!

Serious injury due to electric shock.

- ▶ Exercise particular caution when working with liquids and electrical devices at the same time.
- ▶ Never immerse the motor unit in liquids or rinse with liquids.
- ▶ Disconnect from the mains immediately in the event of contact between the motor unit and liquids.
- ▶ Disconnect from the mains before carrying out repair work.
- ▶ Never touch the mains plug with wet hands.

Cleaning the motor unit

- Clean the motor unit (2) with a slightly damp cloth and a small amount of detergent.

Cleaning the motor protection filter (dry vacuuming)

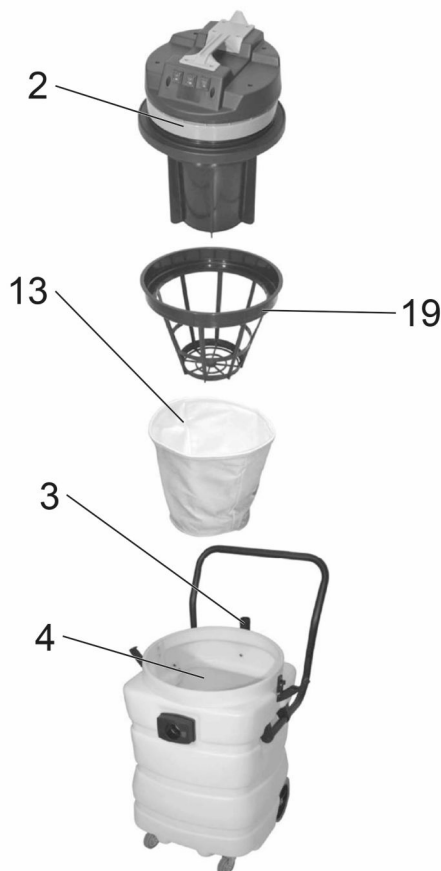

- ➔ Clean the motor protection filter (13) each time the collection container (4) is emptied.
- Remove the motor protection filter (13) from the shoulder (19) for cleaning.
 - Rinse the motor protection filter (13) under running water, then carefully press in.
 - Place the wet motor protection filter (13) on the basket and push the rim of the filter fully over the shoulder (19).
 - Allow the motor protection filter (13) to dry fully.
 - Insert the dried motor protection filter (13) into the industrial vacuum cleaner.
 - Replace a damaged motor protection filter (13).

Cleaning the collection container.

- To drain the dirty water, pull the drain hose (3) out its holder and open the stopper.
- To completely empty the collection container (4), tip it over and rinse it out with a water jet.

Cleaning accessories

- Check the accessories for clogging and clean.
- Clean the brushes (6, 15) and the rubber lip (18) at regular intervals.

H Shutdown, decommissioning and disposal

1 Decommissioning

1.1 Shutting down and storing the device

NOTICE

Incorrect storage!

Risk of material damage.

► Always store the device in a dry and frost-free environment.

Storing the device

Requirements

- Device is being taken out of service for more than 2 months (e.g. for operational reasons).
- Device has been prepared for storage as described, see page 24.
- Store the device securely in a dry and frost-free room.
- Protect the device against dust and corrosion, e.g. using a tarpaulin.

1.2 Recommissioning after shutdown

- Thoroughly clean the device.
- Start up the device.
- Perform a complete function check immediately after start-up.

2 Decommissioning and disposal

⚠ WARNING!

Electrical voltage!

Serious injury due to electric shock.

► Disconnect from the mains.

► Ensure dead.

► Cut through the connecting cable before disposal.

Disposing of the device

- Dispose of the packaging by type.
- If the device can no longer be used, ask the relevant waste disposal association for information on the necessary disposal measures.
- Do not dispose of the device with domestic waste.